

**⚠ CAUTION - light fitting must be installed by a licensed electrician.**

- Please ensure to read instructions correctly for the installation of the fitting provided. Failure to do so will result in a void of warranty and compromises the safety of luminaire.
  - Radiant Lighting are not liable for warranties when luminaire is damaged by incorrect installation. The installation of the luminaires must be in accordance with the national safety regulations.
  - If the external flexible cable or cord of the luminaire is damaged, it shall be exclusively replaced by the manufacture or his service agent or similar qualified person in order to avoid a hazard.
- Please refer to Radiant Lighting's General Terms & Conditions for more information concerning the installation and warranty of our products.

Wiring Option A

**A1 (Overview):**

Before starting, ensure you have a flathead screwdriver, your connection box and Faze Starlight drive ready.

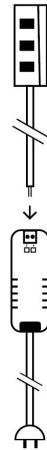

**A2 (Connect up Connection Box):**

By placing the black cable into the negative and the red cable into the positive.

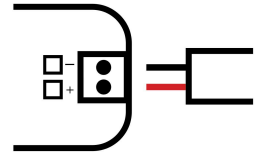

**A3 (Optional Wiring):**

If you choose not to use the Connection Box, there is a secondary plug for hard wiring. Make sure it is wired in series.

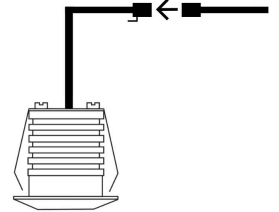

Wiring Option B

**B1 (Connect Faze Starlight into Connection Box):**

Start plugging Faze Starlight (min. 2) into the Connection Box. If the cable isn't long enough, simply extend it with a 12V cable.

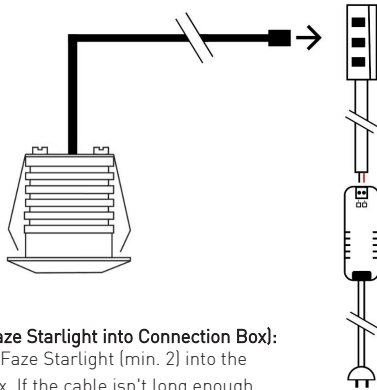

**B2 (Ensure all slots in Connection Box are filled):**

If there are any empty slots, ensure circuit stoppers are used to fill them.

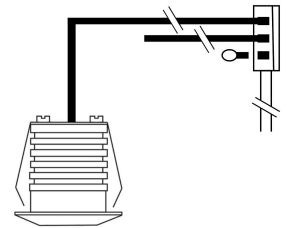

**B3 (Removal):**

The circuit stoppers have a lock function. They can be removed simply with a flathead screwdriver and pressing down on the inside of the clip.

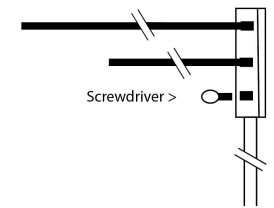

<b>Category</b> Recessed Downlight	
<b>Power</b> 3W	
<b>IP Rating</b> 65	
<b>Material</b> Powder Coat Aluminium	
<b>Warranty</b> 3 Years	

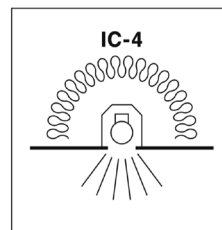

Suitable for residential or commercial use in Australia and New Zealand. Fitting may be abutted and covered according to AS/NZS 60598.2.2:2016, however for optimal efficiency we advise that the luminaire is not covered when installing.

**WARNING – RISK OF OVERHEATING OR FIRE IF THE CLEARANCE DISTANCES ARE COMPROMISED.** Minimum clearance for luminaire: In accordance with AS/NZS 60598.2.2:2016

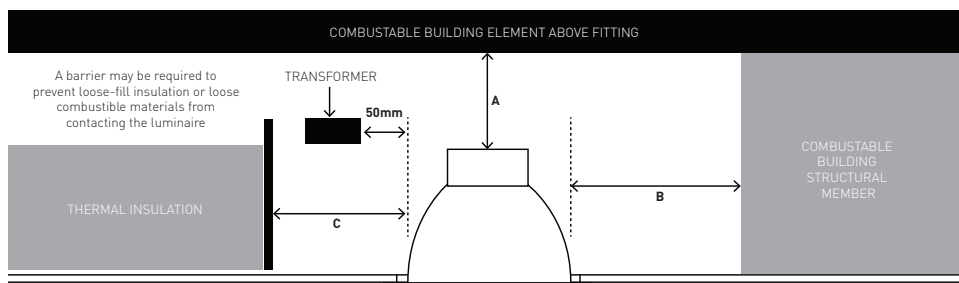

**A** Height clearance to building element (HCB) = **0mm**

**B** Side clearance to building element (SCB) = **0mm**

**C** Side clearance to insulation (SCI) = **0mm**